

vtech®

Parent's Guide

Too-Too  
Drivers®

Dumper Truck



91-003862-000 (UK)

# INTRODUCTION

Thank you for purchasing the **Toot-Toot Drivers® Dumper Truck** by **VTech®**. Transform from dumper truck to fun stunt ramp!! Dumper truck's 3 learning buttons introduce numbers and objects! Gather all your Toot-Toot Drivers® friends for loads of fun!



## INCLUDED IN THIS PACKAGE

- One **Dumper Truck**
- One Mini Vehicle
- Two Rock Accessories
- One Parent's Guide

### **WARNING:**

All packing materials such as tape, plastic sheets, packaging locks, removable tags, cable ties and packaging screws are not part of this toy and should be discarded for your child's safety.

**NOTE:** Please keep this Parent's Guide as it contains important information.

Please cut and discard the strings that attach the vehicle to the unit before playing.

### **Unlock the packaging locks:**

- ① Rotate the packaging locks 90 degrees anticlockwise.
- ② Pull out the packaging locks.

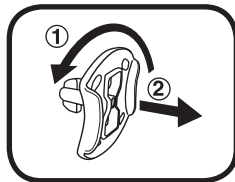

# GETTING STARTED

## BATTERY REMOVAL AND INSTALLATION

1. Make sure the unit is turned **OFF**.
2. Locate the battery cover on the bottom of the **Dumper Truck**. Use a coin or a screwdriver to loosen the screw and open the battery cover.
3. Remove old batteries by pulling up on one end of each battery.
4. Install 2 new AAA (AM-4/LR03) batteries following the diagram inside the battery box. (The use of new alkaline batteries is recommended for maximum performance).
5. Replace the battery cover and tighten the screw to secure.

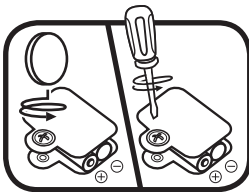

## BATTERY NOTICE

- Use new alkaline batteries for maximum performance
- Use only batteries of the same or equivalent type as recommended
- Do not mix different types of batteries: alkaline, standard (carbon-zinc) or rechargeable, or new and used batteries
- Do not use damaged batteries
- Insert batteries with the correct polarity.
- Do not short-circuit the battery terminals.
- Remove exhausted batteries from the toy.
- Remove batteries during long periods of non-use.
- Do not dispose of batteries in fire.
- Do not charge non-rechargeable batteries.
- Remove rechargeable batteries from the toy before charging (if removable).
- Rechargeable batteries are only to be charged under adult supervision.

**WE DO NOT RECOMMEND THE USE OF RECHARGEABLE BATTERIES.**

## Disposal of batteries and product



The crossed-out wheellie bin symbols on products and batteries, or on their respective packaging, indicates they must not be disposed of in domestic waste as they contain substances that can be damaging to the environment and human health.



The chemical symbols Hg, Cd or Pb, where marked, indicate that the battery contains more than the specified value of mercury (Hg), cadmium (Cd) or lead (Pb) set out in Battery Directive (2006/66/EC).

The solid bar indicates that the product was placed on the market after 13th August, 2005.

Help protect the environment by disposing of your product or batteries responsibly.

For more information, please visit:

[www.recycle-more.co.uk](http://www.recycle-more.co.uk)

[www.recyclenow.com](http://www.recyclenow.com)

## PRODUCT FEATURES

### 1. Off/Low/High Volume Control Switch

To turn the unit **On**, slide the **Off/Low/High Volume Control Switch** to the Low Volume (◀) or the High Volume (▶) position. You will hear a song, phrase and a playful sound. To turn the unit **Off**, slide the **Off/Low/High Volume Control Switch** to the **Off** ● position.

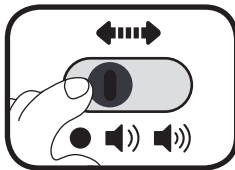

### 2. Automatic Shut Off

To preserve battery life, the **Toot-Toot Drivers® Dumper Truck** will automatically power down after approximately 65 seconds without input. The unit can be turned on again by pressing the Light Up Buttons, pulling the lever or pushing the **Dumper Truck** quickly.

**NOTE:** If the unit powers down or the light fades out during playing, please install a new set of batteries.

## ACTIVITIES

### 1. Off/Low/High Volume Control Switch

Slide the **Off/Low/High Volume Control Switch** to turn the **Dumper Truck** on. You will hear a song, phrases and playful sounds. The lights will flash with the sounds.

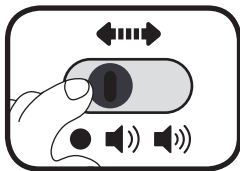

### 2. Light Up Buttons

Press the **Light Up Buttons** to learn about numbers and objects. You will also hear playful songs, melodies and phrases. The lights will flash with the sounds.



### 3. Wheel Sensor

Push or pull the **Dumper Truck** to hear playful sounds and tunes. When a melody is playing, push or pull the **Dumper Truck** to add fun sounds on top of the melody. The lights will flash with the sounds.



### 4. Lever

Pull the **Lever** to hear playful sounds and tunes. The lights will flash with the sounds.



### 5. Dumper Truck Box

Fill up the **Dumper Truck Box** then pull the **Lever** to raise it up to unload the cargo.



## 6. **Stunt Ramp**

Unlock the handle and flip down the **Dumper Truck Box** to transform it into a **Stunt Ramp**. Pull the **Lever** to lift up the platform. Put a vehicle on the handle, then raise up the handle to launch the vehicle down the ramp.

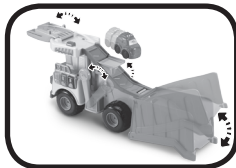

## 7. **SmartPoint™ Location**

Unlock the handle and flip it up. Place any **SmartPoint™** vehicle (each sold separately) on the **SmartPoint™** location to trigger fun sounds, short tunes or phrases.



**NOTE:** If the **Dumper Truck Box** falls apart, insert it back through the small part of the **“T” pin**. You will hear a “click” sound to indicate the pieces are secure.



# SONG LYRICS

## **Song 1**

Load the rocks and hit the road.

To and fro and then unload.

## **Song 2**

It is time to work, at the construction site.

Come with me, from site to site, all day and night.

## **Song 3**

Toot-Toot Drivers!

Toot-Toot Drivers!

I'm a Toot-Toot Drivers dumper truck,

Moving over the road. (Toot-Toot!)  
Loading and unloading, I never feel tired.  
Let's Go! Go! and see! (Toot-Toot!)

## MELODY LIST

1. Turkey in the Straw
2. Three Blind Mice
3. Shoo Fly
4. Old King Cole
5. London Bridge
6. Pop! Goes the Weasel
7. She'll be Coming 'Round the Mountain
8. This Old Man
9. Skip to My Lou

## CARE & MAINTENANCE

1. Keep the unit clean by wiping it with a slightly damp cloth.
2. Keep the unit out of direct sunlight and away from any direct heat source.
3. Remove the batteries when the unit will not be in use for an extended period of time.
4. Do not drop the unit on hard surfaces and do not expose the unit to moisture or water.

## TROUBLESHOOTING

If for some reason the unit stops working or malfunctions, please follow these steps:

1. Please turn the unit **OFF**.
2. Interrupt the power supply by removing the batteries.
3. Let the unit sit for a few minutes, then replace the batteries.



4. Turn the unit **ON**. The unit should now be ready to play again.
5. If the product still does not work, replace with an entire set of new batteries.

If the problem persists, please call our Consumer Services Department and a service representative will be happy to help you.

## CONSUMER SERVICES

Creating and developing **VTech**<sup>®</sup> products is accompanied by a responsibility that we at **VTech**<sup>®</sup> take very seriously. We make every effort to ensure the accuracy of the information, which forms the value of our products. However, errors sometimes can occur. It is important for you to know that we stand behind our products and encourage you to call our Consumer Services Department with any problems and/or suggestions that you might have. A service representative will be happy to help you.

UK Customers:

Phone: 0330 678 0149 (from UK) or +44 330 678 0149 (outside UK)

Website: [www.vtech.co.uk/support](http://www.vtech.co.uk/support)

Australian Customers:

Phone: 1800 862 155

Website: [support.vtech.com.au](http://support.vtech.com.au)

NZ Customers:

Phone: 0800 400 785

Website: [support.vtech.com.au](http://support.vtech.com.au)

## Product Warranty / Consumer Guarantees

UK Customers:

Read our complete warranty policy online at [vtech.co.uk/warranty](http://vtech.co.uk/warranty).

Australian Customers:

**VTECH ELECTRONICS (AUSTRALIA) PTY LIMITED – CONSUMER GUARANTEES**

Under the Australian Consumer Law, a number of consumer

guarantees apply to goods and services supplied by VTech Electronics (Australia) Pty Limited. Please refer to [vtech.com.au/consumerguarantees](http://vtech.com.au/consumerguarantees) for further information.

CLASS 1  
LED PRODUCT



**Visit our website for more  
information about our products,  
downloads, resources and more.**

***[www.vtech.co.uk](http://www.vtech.co.uk)***  
***[www.vtech.com.au](http://www.vtech.com.au)***



TM & © 2020 VTech Holdings Limited.  
All rights reserved.  
**Printed in China.**  
90-003862-000 (X)